

AP MORGAN



TO LET
AP MORGAN
0121 627 6027

Westhorpe Grove, Lozells, Birmingham
£950 per month

Features:

- Upper floor maisonette
- Three bedrooms
- Lounge/diner with balcony
- Convenient sized kitchen
- Family bathroom
- Built in storage space
- On road parking
- EPC- D

Description:

Available from now, this upper floor maisonette has accommodation comprising:

First floor: Entrance hall, lounge/dining room, balcony, convenient sized kitchen with space for cooker/appliances.

Second floor: Landing, two double bedrooms, single bedroom, bathroom with WC, wash hand basin and bath. On road parking can be found at the rear of the property subject to availability.

Located within Lozells and East Handsworth, this is a particularly popular area for families in proximity to Birmingham City Centre and national transport links accessed via bus, rail and road.

Details:

Entrance Hall

Kitchen 9'5" x 8'11" (2.87m x 2.72m)

Lounge/ Diner 14'8" x 16'6" (4.47m x 5.03m)

Balcony

First Floor Landing

Master Bedroom 14'9" x 9'1" (4.5m x 2.77m)

Bedroom Two 11'10" x 9' (3.6m x 2.74m)

Bedroom Three 11'8" x 7'2" (3.56m x 2.18m)

Bathroom 8'9" x 7'3" (2.67m x 2.2m)



EPC Rating: D

Council Tax Band: A (tbc by solicitors).

Tenure: To be advised (tbc by solicitors).

For more information or to arrange a viewing, please call us
on 0121 827 6827.

How can we help you?

Need a mortgage?

We recommend Wiser Mortgage Advice. They will search the market for you to ensure you get the right lender and mortgage deal. They typically achieve mortgage offers much more quickly than if you were dealing with lenders directly. The initial appointment is free and without obligation. Call us on 0121 827 6827, or visit their website for more information: www.wisermortgageadvice.co.uk

Property to sell?

If you need to sell a property in order to buy, you ideally need to be on the market at least (and preferably Sold STC) before viewing, otherwise you may lose out to other buyers when the right property comes along. In these circumstances we can get your property 'live' quickly. Just book a free valuation and we will visit your property and discuss your needs.

Need a solicitor?

A good solicitor can save you literally weeks of time in the buying/selling process, reducing the stress levels of all involved. We will instruct a reputable firm that is competitive on cost and very reliable. Just ask for a quote.

Need a removal company and storage?

A professional removal company takes the stress out of moving, knowing that your belongings are safe and insured far outweighs any small savings by trying to do it yourself or using a man-and-a-van service. We work closely with and recommend Cube Removals as the leading local firm. For peace of mind and a reliable service call them on 0800 193 0000 or visit their website, cuberemovals.co.uk, to arrange a survey.

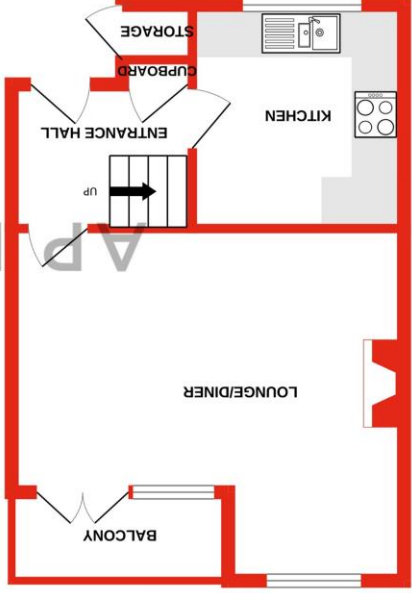

GROUND FLOOR
345 sq.ft. (32.1 sq.m.) approx.

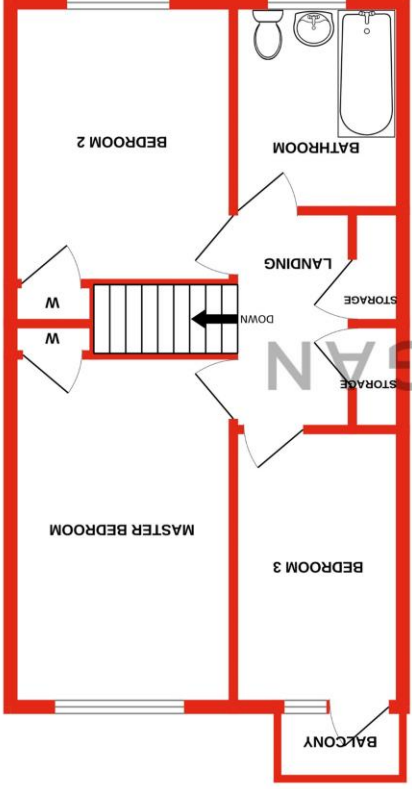

1ST FLOOR
490 sq.ft. (45.5 sq.m.) approx.

While every attempt has been made to ensure the accuracy of the layout and dimensions, measurements of doors, windows, rooms and any other items are approximate and no responsibility is taken for any error, omission or mis-statement. This plan is for illustrative purposes only and should be used as such by any prospective purchaser. The services, systems and appliances shown have not been tested and no guarantee, as to their operability or efficiency can be given. Made with Metrelogix ©2024

No statement in these details is to be relied upon as representation of fact, and purchasers should satisfy themselves by inspection or otherwise as to the accuracy of the statements contained within. These details do not constitute any part of any offer or contract. AP Morgan and their employees and agents do not have any authority to give any warranty or representation whatsoever in respect of this property. These details and all statements herein are provided without any responsibility on the part of AP Morgan or the vendors. Equipment: AP Morgan has not tested the equipment or central heating system mentioned in these particulars and the purchasers are advised to satisfy themselves as to the working order and condition. Measurements: Great care is taken when measuring, but measurements should not be relied upon for ordering carpets, equipment, etc. The Laws of Copyright protect this material. AP Morgan is the Owner of the copyright. This property sheet forms part of our database and is protected by the database right and copyright laws. No unauthorised copying or distribution without permission.